

Section II.

TM 9-2320-280-24P-1

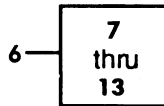

USE WITH BASIC AND A1 VEHICLES (60 AMP)

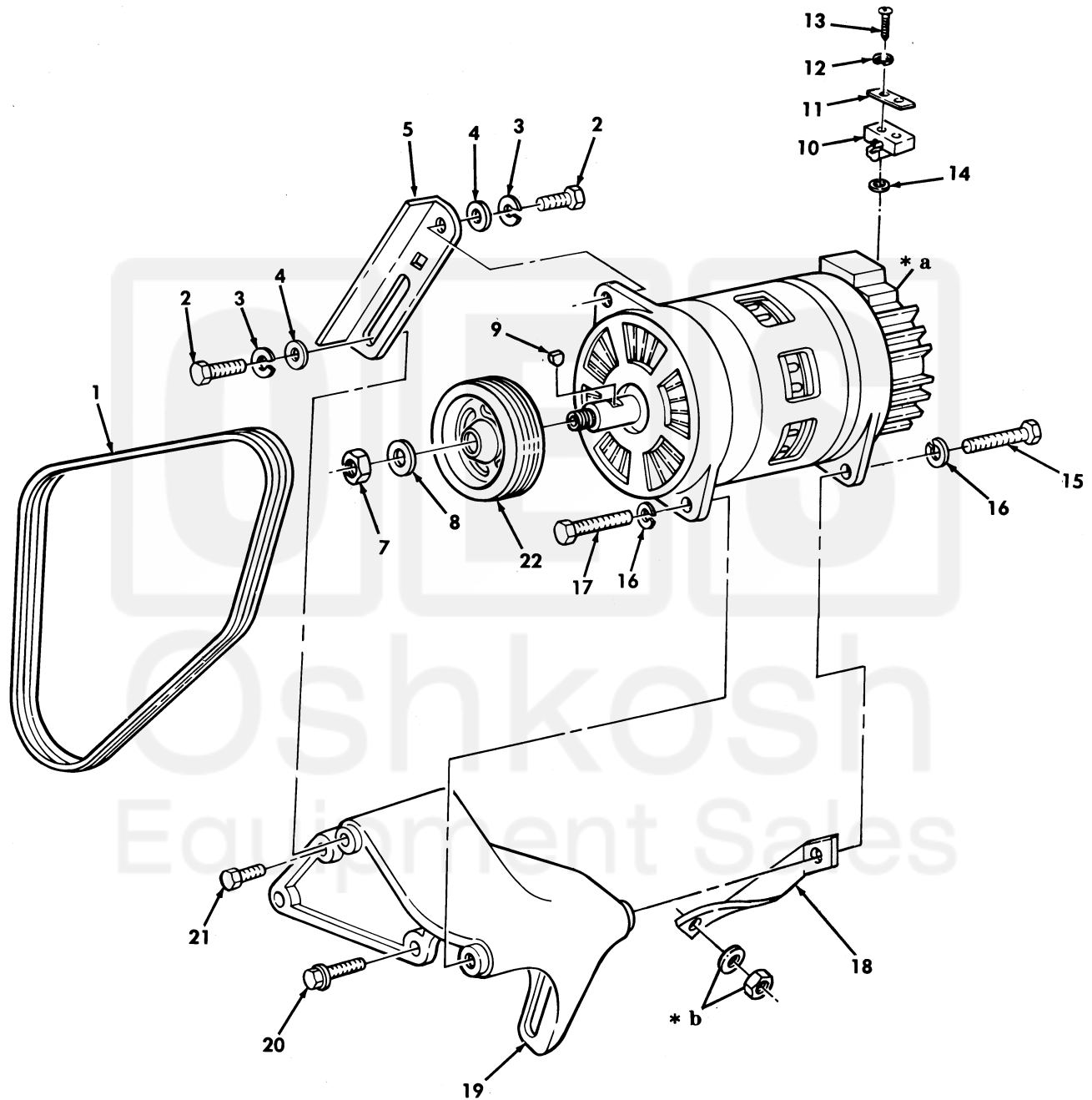

\* a PART OF ITEM 6

\* b SEE FIGURE 42

Figure 35. Generator, 60 AMP, 100 AMP, Belts, Pulley, and Mounting Hardware.

SECTION II		TM9-2320-280-24P				
(1)	(2)	(3)	(4)	(5)	(6)	(7)
ITEM NO	SMR CODE	NSN	CAGEC	PART NUMBER	DESCRIPTION AND USABLE ON CODES(UOC)	QTY
GROUP 06 ELECTRICAL SYSTEM						
0601 GENERATOR: ALTERNATOR						
FIG. 35 GENERATOR, 60 AMP,100 AMP, BELTS,PULLY,AND MOUNTING HARDWARE						
1	PAOZZ	3030012826968	34623	12339359-12	BELTS,V,MATCHED SET.....	1
					UOC:A11,A13,A14,A20,A24,A25,A26,A27,B17,B18,H11,H13,H14,H17,H18,H20,H21,H24,H25,H26,H27,H28,MMM	
2	PAOZZ	5305000680510	80204	B1821BH038C100N	SCREW,CAP,HEXAGON H 3/8-16 X 1.00..	2
					UOC:A11,A13,A14,A20,A24,A25,A26,A27,B17,B18,H11,H13,H14,H17,H18,H20,H21,H24,H25,H26,H27,H28,MMM	
3	PAOZZ	5310006379541	96906	MS35338-46	WASHER,LOCK 3/8.....	2
					UOC:A11,A13,A14,A20,A24,A25,A26,A27,B17,B18,H11,H13,H14,H17,H18,H20,H21,H24,H25,H26,H27,H28,MMM	
4	PAOZZ	5310014124013	24617	2436163	WASHER,FLAT 3/8.....	2
					UOC:A11,A13,A14,A20,A24,A25,A26,A27,B17,B18,H11,H13,H14,H17,H18,H20,H21,H24,H25,H26,H27,H28,MMM	
5	PAOZZ	2920011687914	19207	12338792	GENERATOR BRACKET.....	1
					UOC:A11,A13,A14,A20,A24,A25,A26,A27,B17,B18,H11,H13,H14,H17,H18,H20,H21,H24,H25,H26,H27,H28,MMM	
6	PAOZZ	2920009092483	19207	10929868	GENERATOR,ENGINE AC.....	1
					UOC:A11,A13,A14,A20,A24,A25,A26,A27,B17,B18,H11,H13,H14,H17,H18,H20,H21,H24,H25,H26,H27,H28,MMM	
7	PAOZZ	5310004492381	96906	MS21245-L10	.NUT,SELF-LOCKING,HE 5/8-18.....	1
					UOC:A11,A13,A14,A20,A24,A25,A26,A27,B17,B18,H11,H13,H14,H17,H18,H20,H21,H24,H25,H26,H27,H28,MMM	
8	PAOZZ	5310006143505	96906	MS15795-820	.WASHER,FLAT 5/8.....	1
					UOC:A11,A13,A14,A20,A24,A25,A26,A27,B17,B18,H11,H13,H14,H17,H18,H20,H21,H24,H25,H26,H27,H28,MMM	
9	PAOZZ	5315006165526	80205	MS35756-8	.KEY,WOODRUFF.....	1
					UOC:A11,A13,A14,A20,A24,A25,A26,A27,B17,B18,H11,H13,H14,H17,H18,H20,H21,H24,H25,H26,H27,H28,MMM	
10	PAOZZ	5365012894434	19207	12357116	.SPACER,PLATE.....	1
					UOC:A11,A13,A14,A20,A24,A25,A26,A27,B17,B18,H11,H13,H14,H17,H18,H20,H21,H24,H25,H26,H27,H28,MMM	
11	PAOZZ	5365012897852	19207	12357126	.SPACER,PLATE.....	1
					UOC:A11,A14,A15,A20,A24,A25,A26,A27,B17,B18,H11,H13,H14,H17,H18,H20,H21,H24,H25,H26,H27,H28,MMM	
12	PAOZZ	5310007217809	96906	MS35340-43	.WASHER,LOCK #10.....	2
					UOC:A11,A13,A14,A20,A24,A25,A26,A27,B17,B18,H11,H13,H14,H17,H18,H20,H21,	